

PHILADELPHIA IN 2012

A BID FOR SMOFCON 30



PHILADELPHIA IN 2012

- Friday, November 30—
Sunday, December 2, 2012
- Hyatt Regency
Philadelphia Penn's
Landing
- A weekend of panels &
workshops on conference-
planning & team-building



PHILADELPHIA IN 2012

- Hundreds of world-class restaurants
- One of the best beer cities



PHILADELPHIA IN 2012



- Direct flights from many cities
- Major Amtrak station
- Bus service on many lines

PHILADELPHIA IN 2012

- Liberty Bell Pavilion and Independence Hall
- Constitution Center and President's House
- Philadelphia Art Museum
- Rodin Sculpture Museum
- Franklin Institute of Science and Technology



PHILADELPHIA IN 2012

- Daytime temperature should be between 40 and 60F (4 and 15C).
- In late fall, the Philadelphia area is more likely to have rain rather than snow.



PHILADELPHIA IN 2012

The Hotel

- Hyatt Regency Penn's Landing
- Delaware River Views
- Downtown Site

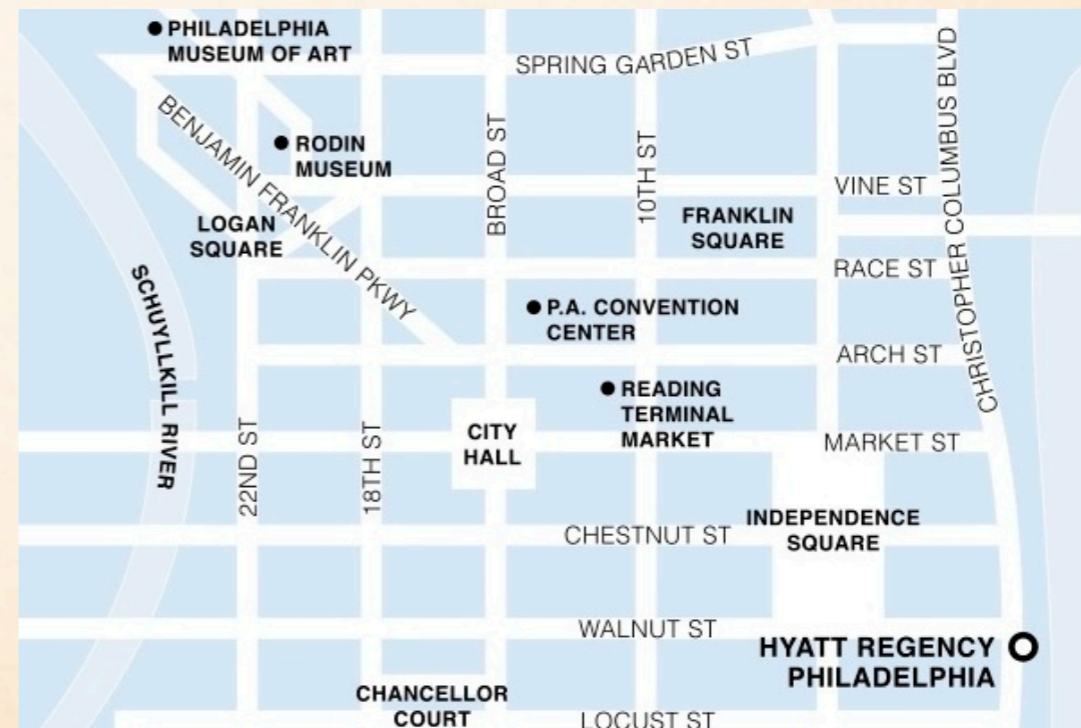

PHILADELPHIA IN 2012

Hyatt Regency Rates

- \$149 single/double
- \$169 triple
- \$189 quad



PHILADELPHIA IN 2012

- Compact function space
- Program: 3rd Floor
- Con Suite: 21st Floor Suite
- Non-smoking & ADA compliant hotel

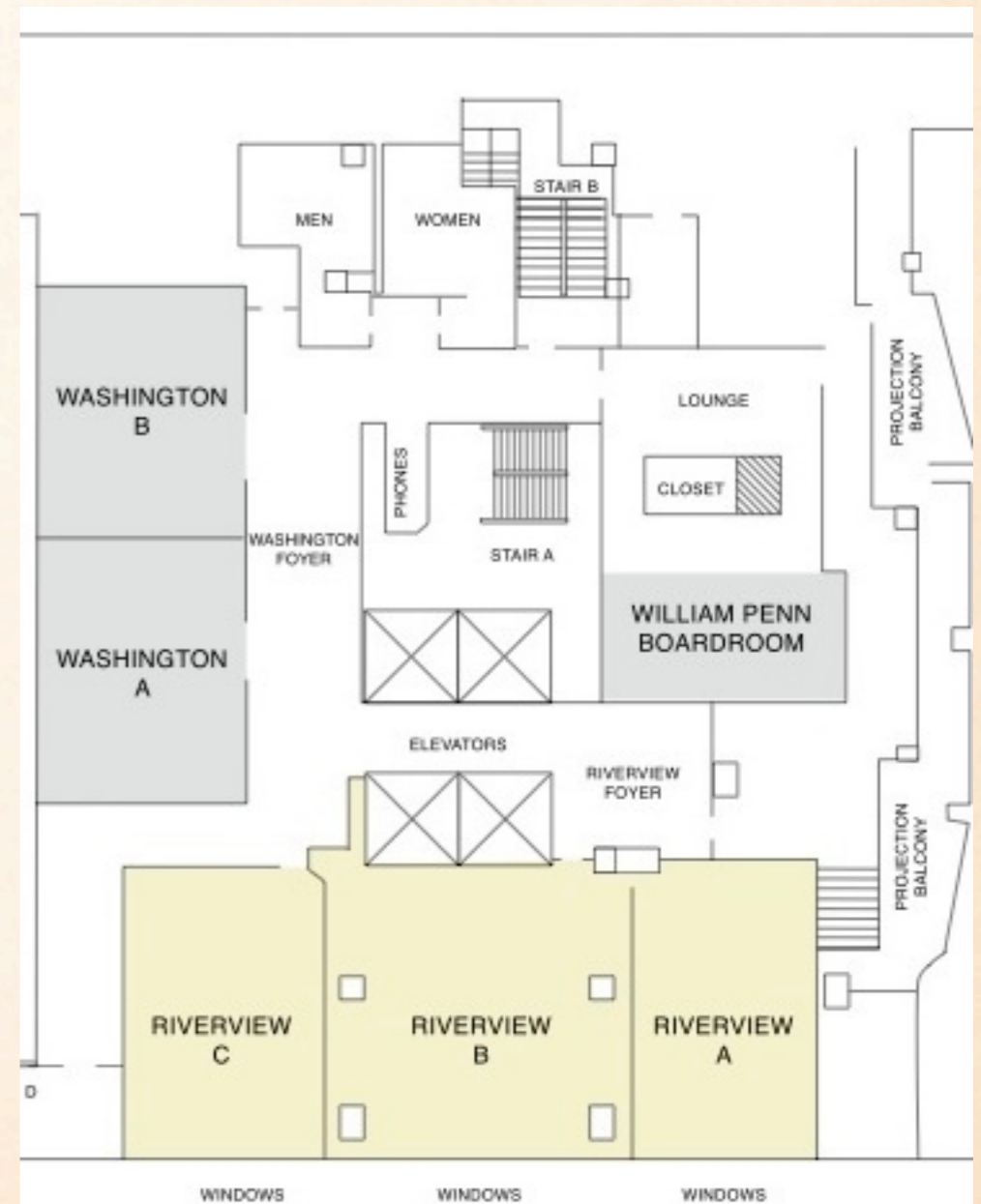

PHILADELPHIA IN 2012

The Theme

- Building a Winning Team: The Right Player for the Right Position
- Evaluating others
- Evaluating yourself



PHILADELPHIA IN 2012

The Committee

- Joni Dashoff
- Laurie Mann
- Ben Yalow
- Todd Dashoff
- Jim Mann

PHILADELPHIA IN 2012

Many Thanks to

- Danny Lieberman
- Hyatt Regency
- Anthrocon

